

# AutoTap AT400 Installation Instructions

1. If any part of your plumbing fixtures such as, the faucet, water service valves or water supply lines are worn, this is a good time to replace them.
2. No plumbing systems or sink cabinets are the same or made to the same standard. Some improvising may be necessary.
3. Do not use any power tools to tighten any screws. Use a manual screwdriver.
4. For an easy and trouble free installation, follow each step in sequence.
5. Keep this installation instruction for your reference.

Step 1 Drill a 3/8" or 9 mm hole on the cabinet floor under the service valves as shown Fig A



Step 2 In the toe kick area of the cabinet, choose a convenient location where you would like your pedal to be installed. Normally that is where the working foot will be standing. Fig B



Step 3 Place the bottom of the template directly on the floor and mark the three centers using a sharp object like an awl. Fig A

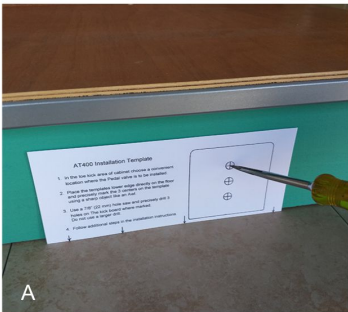

Step 4 Use a 7/8" or 22 mm hole saw and precisely drill 3 holes on the kick plate where marked. Fig B.

**Do not use a larger hole saw than specified.**



Step 5 Using a wood file, enlarge the 3 holes to achieve the outlined shape in image B. If your kick board has a molding at it's base, the molding must be cut to accommodate the pedal. **(Do not install the pedal above molding)**

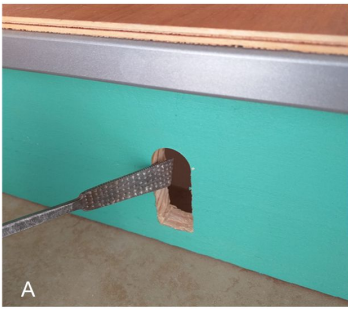

Step 6 Insert the wire with attached pin and magnet down until the magnet touches the floor. Fig A.

Follow the instruction in the switch wire package and while feeding in the wire from the top, pull the wire from the pedal opening until the switch wire is out. Fig B.

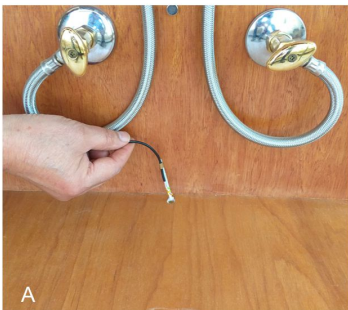

Step 7 Turn off the faucet and water service valves hot and cold under the sink. Disconnect the faucet lines from the service valves. Not shown.

Step 8 Connect faucet "hot" line to left manifold "Out" port and "cold" to the right "out" port of the manifold. Fig. A

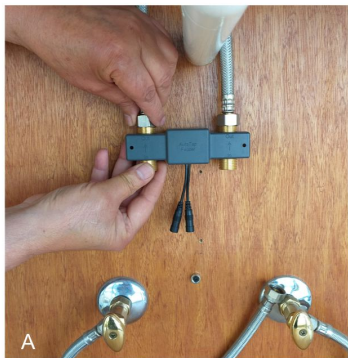

Step 9 Using the provided tubes; connect water supply valves "Hot" to the left "In" port and "Cold" to the right "In" port of the manifold. Fig B

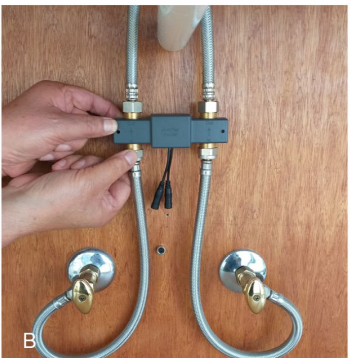

Step 10 Connect the module's two black male connectors Fig A to the manifold female connectors. Any male connector can be connected to any female connector.

Step 11 Connect the module's black switch connector to the pedal connector. Fig B

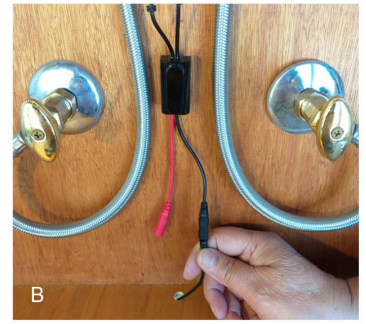
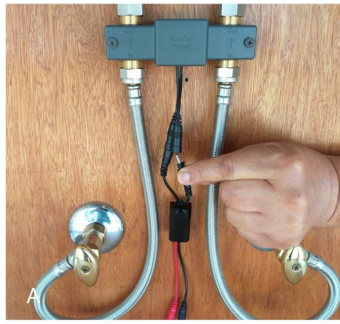

Step 12 Connect the wire coming out of the pedal opening to the pedal switch Fig A.

Any color wire, red or white, can be connected to any switch screws.

Step 13 Place the bottom of pedal back plate on the floor Fig B and fasten the upper 2 screws and 2 lower screws. Fig B

Do not use power tools.

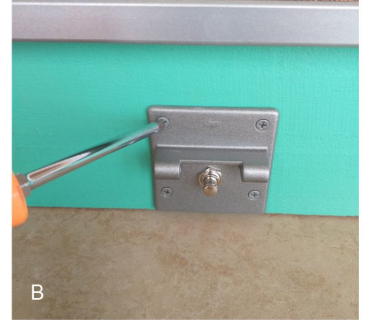
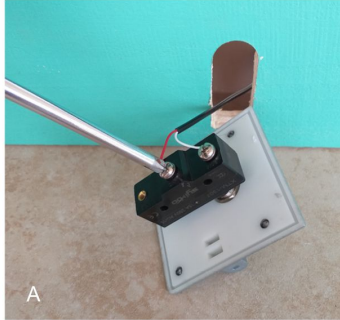

Step 14 Using the provided 2 screws and washers, fasten the pedal to the back plate. Fig A

Do not fully tighten. Pedal should be slightly loose to move up and down freely.

Step 15 Connect the module's red connector to the battery pack. Fig B

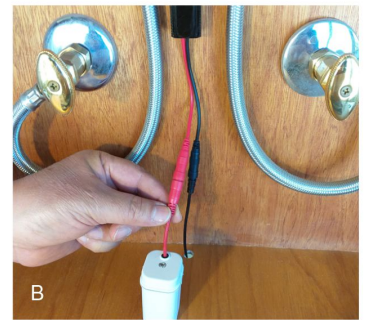

Step 16 Turn on your faucet hot and cold, middle position. Then turn on the water service valves hot and cold. Fig A Test the system by pushing on the pedal.

Step 17 Check the manifold water connections for leaks, making sure all water line connections are tight and dry.

