

AutoTap AT200HC- AT700HC Instalation Instructions

1. If any part of your plumbing fixtures such as; the faucet, water service valves or water supply lines are worn, this is a good time to replace them.
2. No plumbing systems or sink cabinets are made the same or to the same standard. Some improvising may be necessary.
3. Do not use any power tools to tighten any screws. Use a manual screwdriver.
4. For an easy and trouble free installation, follow each step in sequence.
5. Keep this installation instruction for your reference.

Step 1 Drill a ½” or 12 mm hole on the cabinet floor under the service valves as shown Fig A

Step 2 In the toe kick area of the cabinet, choose a convenient location where you would like your pedal to be installed. Normally that is where the working foot will be standing. Fig B



Step 3 Place the bottom of the template directly on the floor and mark the 6 centers using a sharp object like an awl. Fig A

Step 4 Use a 1” or 24 mm hole saw and precisely drill 6 holes on the kick plate where marked. **Do not use a larger hole saw than specified.**

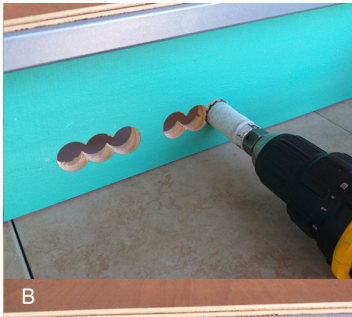
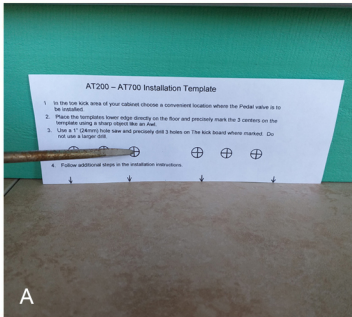

Step 5 Using a wood file; enlarge the 6 holes to achieve the outlined shape in Fig B. If your kick board has a molding at its base, the molding must be cut to accommodate the pedal. **(Do not install the pedal above the molding)**



Step 6 Insert 1 switch wire with attached pin and magnet down until the magnet touches the floor. Fig A

Follow the instructions in the switch wire package and while feeding in the wire from the top, pull the wire from the pedal opening until the switch wire is out. Fig B
Repeat the above for pulling the second switch wire.

Step 7 Turn off the faucet and water service valves hot and cold under the sink. Disconnect the faucet lines from the service valves. Not shown.

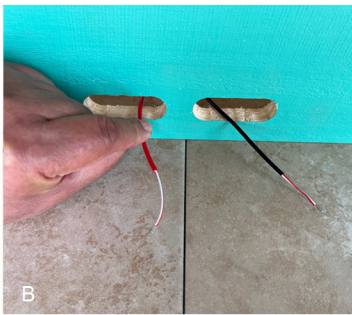

Step 8 Connect faucet “hot” line to left manifold “Out” port and “cold” to the right “Out” port of the manifold. Fig A

Step 9 Using the provided tubes; connect water supply valves “Hot” to the left “In” port and “Cold” to the right “In” port of the manifold. Fig B

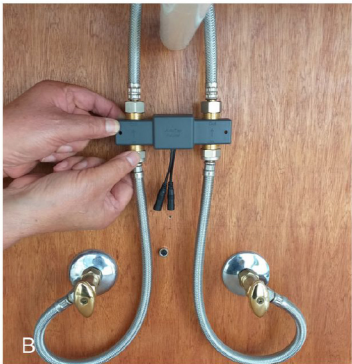
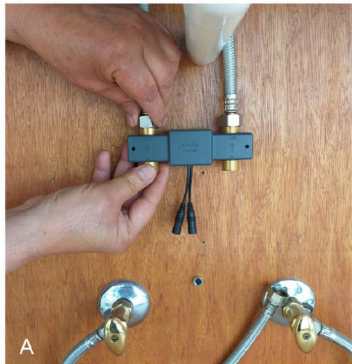

Step 10 Connect the module's black and red connectors Fig A to the manifold black and red connectors.

Step 11 Connect the module's black and red switch connector to the pedal black and red connector. Fig B

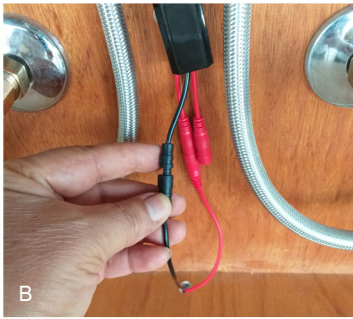
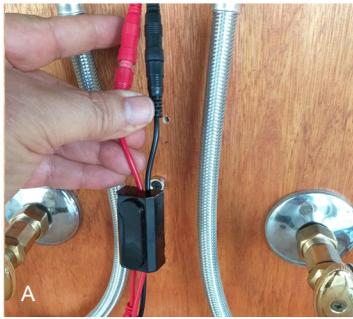

Step 12 Connect the wires coming out of the pedal opening to the pedal switches. For hot water, connect red wire to left switch, for cold to the right switch. Fig A

Step 13 Place the bottom of pedal back plate on the white spacer and fasten the upper 4 screws and 3 lower screws. Fig B Remove the spacer after finished.

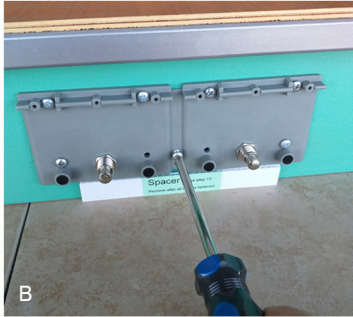
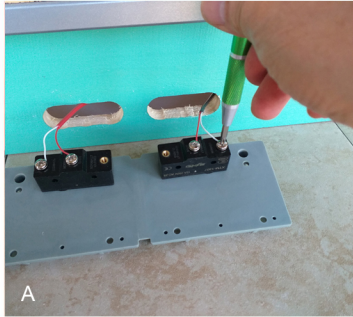

Step 14 Place the left pedal cover on the base, and by using a #2 Philips screw driver, fasten the 3 screws. Fig A **Do not fully tighten the screws.** All five screws should be slightly loose to allow the pedal plate to swivel on its pivots. Repeat the above step for the right pedal cover.

Step 15 Connect the module's red connector to the battery pack. Fig B

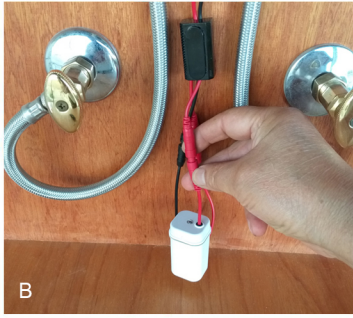
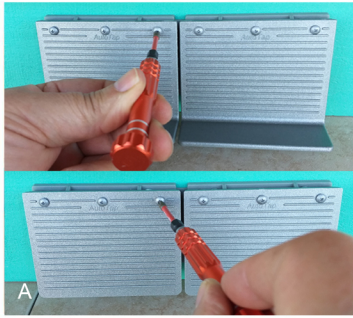

Step 16 Turn on your faucet hot and cold or middle position. Then turn on the hot and cold water service valves. Fig A Test the system by pushing on the pedals.

Step 17 Check the manifold water connections for leaks, making sure all water lines connections are tight and dry.

