

AutoTap AT700 Kick Activated Faucet Controller

Technical Specs

Valve Manifold

Valve Manifold Specifications:

Material: Brass valve - High impact ABS casing
Pressure rating: 20 - 120 psi 138 - 827kpa
Operating pressure: 60 psi 413 kpa
Flow rate: 8 gpm @ 60psi 30.2 L/m @ 413 kpa
Mounting position: No restrictions
Inlet port Filtration: yes
Power requirement: 6v dc
Inlet port connections: 1/2" SPT (straight pipe threads)
Outlet ports connections: 1/2" SPT (straight pipe threads)
Outlet ports adaptor: 1/2" x 3/8"

Shipping weight: 3 lb

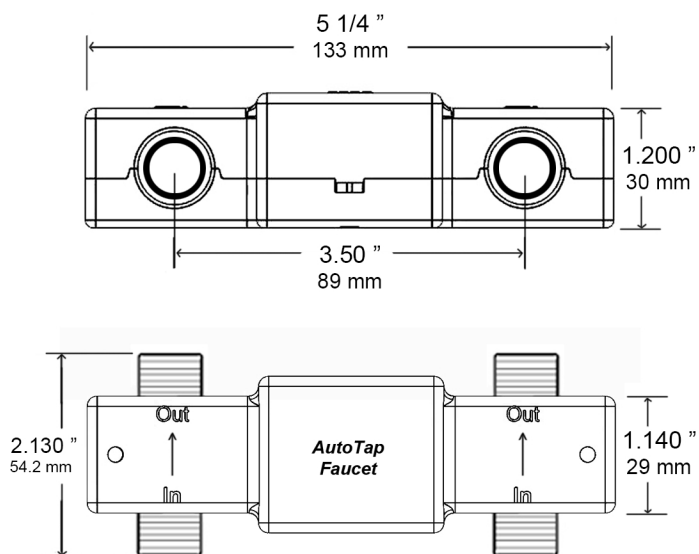

AT700 Kick Activated Controller

Specifications:

AT 700

Material: High impact ABS
Actuation movement: 1/8"
Mounting position: Upright
Actuation force: 5 oz
Power requirement:

All dimensions on the stainless steel controllers are within the tolerance of ± 1.5 mm

To view installation instructions, Please visit our website at: autotapfaucet.com

